

**ARIZONA GAME AND FISH DEPARTMENT
 HABITAT PARTNERSHIP COMMITTEE
 HABITAT ENHANCEMENT AND WILDLIFE MANAGEMENT PROPOSAL**

Game Branch / HPC Project Number:	16-305
-----------------------------------	--------

PROJECT INFORMATION

Project Title: Dirt tank cleanouts plus some bentonite work for Yavapai Ranch in association with MDF.

Region and Game Management Unit: Region III, 17A and 19B

Local Habitat Partnership Committee (LHPC): <ul style="list-style-type: none"> Yavapai Regional HPC 	Was the project presented to the LHPC? YES[] NO[X]
--	--

Has this project been submitted in previous years? YES[] NO[X]
If Yes, was it funded? YES[] NO[] → **Funded HPC Project #(s):**

Project Type: Dirt tank cleanouts and repair.

Brief Project Summary:
 . Clean out 13 priority dirt tanks on the Yavapai Ranch with one requiring bentonite. Improve water availability for mule deer and other wildlife species as well as livestock on Yavapai Ranch while strengthening landowner relationships.

The Prescott Chapter of the Mule Deer Foundation (MDF) recently joined the Cooperative Resource Management Program on the Yavapai Ranch and initiated an Adopt-a-Ranch relationship with the ranch Owner Fred Ruskin. AZ Game and Fish Dept. currently has a Landowner Access Agreement with Yavapai Ranch.

Big Game Wildlife Species to Benefit (% benefit per species) : Mule Deer 50%, Pronghorn 10%, Javelina 10%, Elk 10%, Mountain Lion 10%, Turkey 5%, Black Bear 5%

Implementation Schedule (Month/Day/Year): Project Start Date: February 2017 Project End Date: December 2017	Environmental Compliance: NEPA Completed: Yes[] No[] N/A[X] Projected Completion Date: _____ State Historic Preservation Office - Archaeological Clearance: (Provide Attachment) Yes[] No[] N/A[X] Projected Completion Date: _____ Arizona Game and Fish Department EA Checklist: N/A[X] To be Completed by: _____ Projected Completion Date: _____
--	--

PROJECT FUNDING

Special Big Game License Tag Funds Requested:	\$ 15,900.00 for purchase of the use of a Dozer, (\$6,900), bentonite (\$4,000), fuel costs (\$2,000), labor costs (\$2,000), and maintenance cost (\$1,000 est.).
Cost Share or Matching Funds:	\$ 4,714.88 for labor performed by a combination of MDF and Yavapai Ranch personnel for planning and implementation on private sections of the ranch. (\$2000.00) for donated labor cost from John Sandri for operation of equipment to complete the tanks. (\$1,357.44) for 12 days of ranch personnel planning performed by Ranch Manager Will Smith and associates along with Kevin Hall, John Sandri, and Terry Herndon with MDF. (\$1,357.44) for 12 days of implementation from Will Smith with Yavapai Ranch and associates to be sure the dirt tanks are dug to previous proper depths and widths.
Total Project Costs:	\$20,614.88

PARTICIPANT INFORMATION

Applicant (please print): AZ Game & Fish Department Wildlife Manager II- Jesse Baker	Address: 5325 N. Stockton Hill Road Kingman, AZ 86409	E-mail: JBaker@azgfd.gov
Telephone: (480) 216-7892		Date: 8/27/2016

AGFD Contact and Phone No. (If applicant is not AGFD personnel):

Project has been coordinated with: Fred Ruskin- owner of the Yavapai Ranch, Terry Herndon-MDF, and Kevin Hall- Prescott Chapter MDF.

NEED STATEMENT – PROBLEM ANALYSIS:

The Prescott Chapter of the Mule Deer Foundation (MDF) has recently joined the Cooperative Resource Management Program (CRMP) on the Yavapai Ranch and entered into an Adopt-a-Ranch relationship. Currently, AZ Game and Fish Department has a Landowner Access Agreement with Yavapai Ranch.

Fred Ruskin and the Yavapai Ranch has continuously provided unrestricted access for sportsmen on their ranch unlike the many surrounding ranches which either restrict all access to hunters or offer limited foot access only. The Mule Deer Foundation has recognized the importance of preserving sportsman’s access and the relationships with livestock operators around the Prescott area and are committed to building these relationships and providing habitat for wildlife.

The Yavapai Ranch comprises over 100,000 acres of largely checkerboard private and Prescott

National Forest lands within Northwestern Arizona near Prescott. Historically, the land's predominant big game has been mule deer. Much like other areas throughout Arizona, water availability is a big concern on the Yavapai Ranch which is an area without a perennial stream. The ranch relies on rain and the water table to fill their tanks, which can amount to formidable costs to a working cattle ranch. These tanks provide water for the benefit of wildlife and not just livestock. Helping offset ranch expenses to better ensure reliable water in multiple dirt tanks throughout the ranch for both wildlife and livestock where hunter access is not restricted is a win for all parties involved. These tank cleanouts would otherwise not occur at all or only be done when the situation becomes dire. Offsetting expenses for Yavapai Ranch to benefit wildlife and livestock will help strengthen sportsmen's relationships on the ranch and in turn help preserve access into the future.

PROJECT OBJECTIVES:

Improve water availability for mule deer and other wildlife species on Yavapai Ranch while strengthening landowner relationships.

The objective is to provide dependable water sources for multiple wildlife species as well as livestock on the water limited Yavapai Ranch. The dirt tank cleanouts and the bentonite would occur within private sections on Yavapai Ranch that resides in Game Management Units (GMUs) 17A and 19B.

PROJECT DESCRIPTION AND STRATEGIES:

(How will you implement project)

The Prescott Chapter of the Mule Deer Foundation will facilitate the purchasing of the Dozer, fuel costs, labor costs, maintenance costs, and the purchasing and implementation of the bentonite. Labor will be completed on private sections by the ranch personnel and potentially with dedicated volunteers of the Prescott Chapter of MDF. Wildlife Managers and other key department personnel will be in communication throughout the necessary implementation process as well.

The 13 dirt tanks will be cleaned and dug to the previous depths and widths on private sections of the private land only of Yavapai Ranch. This work will be considered maintenance as only dirt that has since filled in the tanks within the footprint will be removed. Ranch personnel will ensure proper removal of dirt within the footprint occurs.

PROJECT LOCATION

(Please provide lat/long in decimal degrees of project area using datum WGS84. If project is larger than one point, please provide multiple lat/long points or an existing shapefile of the project area)

Tanks listed were provided by Kevin Hall with MDF and were proposed in coordination with Yavapai Ranch, MDF, and Arizona Game and Fish Department Wildlife Manager Jesse Baker.

*See attached map for locations of the following 13 dirt tanks being proposed as follow:

- Brush Tank --on Cienega Road.
- Pine Flat Tank--Pine Springs Road.

- Sec 33 Tank--off Pine Springs Rd;
- Pine springs Draw Tank--about half way between the County Rd and East ranch boundary on Pine Springs Draw.
- Sec 17 Tank: NE border of the ranch.
- Charlie Weston Tank--W of Headquarters on N border of ranch.
- Road Canyon Tank, which needs the Bentonite.
- Antelope Tank- On the west side.
- Smith-Evans Tank- On the west side.
- Pasture 3 Tank-West Side
- New Water Tank- South of Antelope
- Indian Wells- east of Rd 1 North of Powerline Rd
- Sullivan Tank – North of Road Canyon

LAND OWNERSHIP AT THE PROJECT SITE(S):

(If the project area is private property, please state specifically and provide the landowner's name)

- All 13 tanks are on Fred Ruskin's private property within Yavapai Ranch.

IF PRIVATE PROPERTY, IS THERE A COOPERATIVE BIG GAME STEWARDSHIP or LANDOWNER AGREEMENT BETWEEN THE LANDOWNER AND THE DEPARTMENT?

YES[X] NO[] N/A[]

HABITAT DESCRIPTION:

Yavapai Ranch is located at elevations between 5,000ft and 7,000ft, going from grassland to Pinon-Juniper woodlands which is the largest portion to Ponderosa-Oak forests. The predominant range grass is Blue Gramma which is found throughout the ranch. Sideoats Gramma, Wester Wheat, and Squirreltail are the predominant cool season grasses.

ITEMIZED USE OF FUNDS:

Special Big Game License Tag Funds

\$ 15,900.00 for purchase of the use of a Dozer, (\$6,900.00), bentonite (\$4,000), fuel costs (\$2,000), labor costs (\$2,000), and maintenance cost (\$1,000 est.).

Cost Share or Matching Funds (for volunteer labor rates please refer to the worksheet below)

\$ 4,714.88 for labor performed by a combination of MDF and Yavapai Ranch personnel for planning

and implementation on private sections of the ranch. (\$2000.00) for donated labor cost from John Sandri for operation of equipment to complete the tanks. (\$1,357.44) for 12 days of ranch personnel planning performed by Ranch Manager Will Smith and associates along with Kevin Hall, John Sandri, and Terry Herndon with MDF. (\$1,357.44) for 12 days of implementation from Will Smith with Yavapai Ranch and associates to be sure the dirt tanks are dug to previous proper depths and widths.

LIST COOPERATORS AND DESCRIBE POTENTIAL PARTICIPATION:

Mule Deer Foundation- Terry Herndon, Kevin Hall, Prescott Chapter of the Mule Deer Foundation

- Facilitate rental of Dozer, purchase of fuel, use of maintenance funds, labor, purchase of bentonite, as well as scheduling and implementation.

Yavapai Ranch- Fred Ruskin (Owner), Will Smith (Ranch Manager), and various Yavapai Ranch personnel.

- Provide labor and oversee implementation as to specifications.

Arizona Game and Fish Department- Wildlife Managers Jesse Baker (19B).

- Provided in-kind contributions in the form of labor for contract administration, project origination, and project coordination/completion.

WOULD IMPLEMENTATION OF THIS PROJECT ASSIST IN PROVIDING, MAINTAINING, OR FACILITATING RECREATIONAL ACCESS?

YES NO N/A

PROJECT MONITORING PLAN:

N/A

PROJECT MAINTENANCE:

N/A

PROJECT COMPLETION REPORT TO BE FILED BY:

Arizona Game and Fish Department District Wildlife Manager will monitor the project until completion.

WATER DEVELOPMENT PROJECTS (please use the worksheet below):

N/A

TREE CLEARING/REMOVAL PROJECTS (please use the worksheet below):

N/A

ATTACHMENTS:

(Please provide cultural clearance documentation from land management agency, e.g., FONSI, Inventory Standards, etc. Also attach any project pictures)

- Map of Tanks

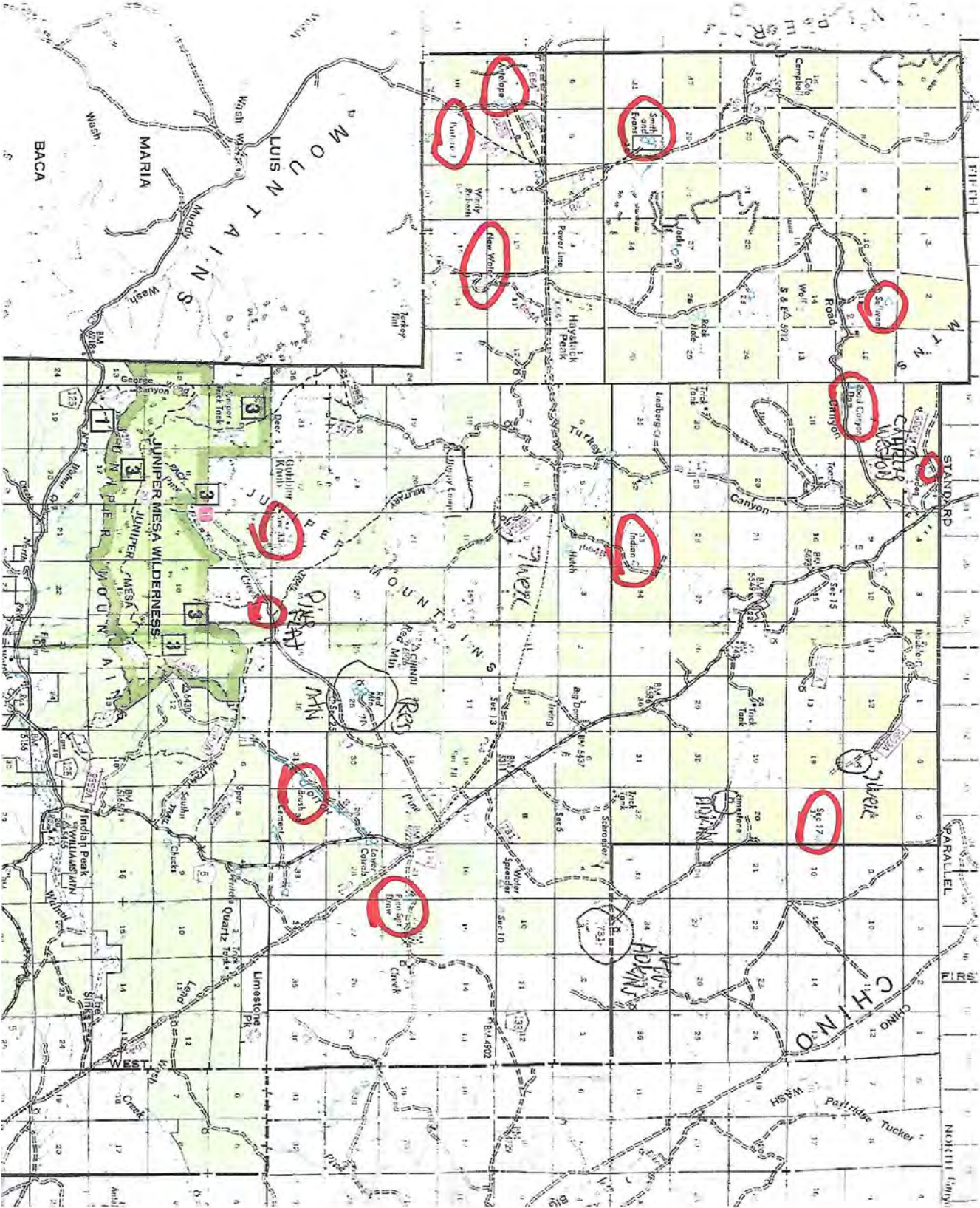

ARIZONA GAME AND FISH DEPARTMENT WATER DEVELOPMENT WORKSHEET

PROJECT TITLE: _____

- 1) **Is the water development listed as a priority in the most recent “Wildlife Water Development Annual Implementation Schedule?”**
- 2) **Please list the Development Branch personnel and date coordinated with for this project.**
- 3) **What is the estimated annual inches of precipitation for the area? (mark one)**
2-4 4-6 6-8 8-10 10-12 12-14 14-16 >16
- 4) **Is there a perennial water source available to big game within four miles of this project?**

YES (please complete #5 below) NO (skip #5 below)

- 5) **For the accessible, perennial water source nearest this project:**

Name of water source:

Type of water source (catchment, spring, dirt tank):

Ownership of water source:

Distance in miles from project:

- 6) **Is the target wildlife species a result of transplant efforts? YES NO**

- 7) **Please list any special land management status for the project site (i.e. Wilderness, National Park, National Monument). If private land, list landowner.**

- 8) **Please provide the following information about access to the proposed site:**

Type of access (mark one): 2x4 vehicles 4x4 only foot only**

**If foot access only: Distance in miles: _____ Approximate hiking time: _____

-- Does access to this site require crossing private or tribal lands? YES NO

-- Please describe any restrictions to public access:

- 9) **Please list below (or on a separate sheet) the material type and dimensions of each component proposed to be added, modified, or repaired.**

- 10) **Was a site visit completed? Yes No**

If Yes, please list personnel that attended and date.

ARIZONA GAME AND FISH DEPARTMENT
TREE CLEARING/REMOVAL WORKSHEET

PROJECT TITLE: _____

- 1) **What is the estimated acreage of the project?**

- 2) **How are the trees going to be cleared? (agra axe, chain saw, grubbing, push, chaining):**

- 3) **What is the estimated number of trees per acre?**

- 4) **Describe trees to be cleared (species, estimated diameter, single stem, multi-stem):**

- 5) **Describe terrain (slope, soil type, rocks)**

- 6) **Please list any special land management status for the project site (e.g. Wilderness, National Park, National Monument). If private land, list landowner.**

- 7) **Please provide the following information about access to the proposed site:**
Type of access (mark one): 2x4 vehicles 4x4 only Foot only**

**If foot access only: Distance in miles: Approx. hiking time:

Does access to this site require crossing private or tribal lands? YES[] NO[]

Is the site relatively accessible for tree removal equipment? YES[] NO[]

Please describe any restrictions to public access:

ARIZONA GAME AND FISH DEPARTMENT

VOLUNTEER HOURLY RATES AND CLASSIFICATIONS WORKSHEET

PROJECT TITLE: Mule Deer Foundation Wildlife Drinker Materials for Yavapai Ranch

The value of volunteer labor should be calculated at the hourly rate of an employee doing similar work, or using hourly rates from the Arizona Department of Administration's Human Resource web site, plus a standard ERE rate of 35%. http://www.hr.state.az.us/ClassComp/CC_Job_Titles_with_Ranges.asp

\$0.445/mile should be the calculation used for mileage.

Water Development	Volunteer Hours	Volunteer Miles	Hourly Rate	Estimated Value
			\$14.14	
Habitat Restoration and Clean Up	Volunteer Hours	Volunteer Miles	Hourly Rate	Estimated Value
			\$14.14	
Fisheries	Volunteer Hours	Volunteer Miles	Hourly Rate	Estimated Value
			\$14.14	
Nongame Branch Project	Volunteer Hours	Volunteer Miles	Hourly Rate	Estimated Value
			\$14.14	
Misc/office work	Volunteer Hours	Volunteer Miles	Hourly Rate	Estimated Value
			varies	
Community Services	Volunteer Hours	Volunteer Miles	Hourly Rate	Estimated Value
			\$7.44	
Events and Other	Volunteer Hours	Volunteer Miles	Hourly Rate	Estimated Value
			\$14.14	
Research Branch	Volunteer Hours	Volunteer Miles	Hourly Rate	Estimated Value
			\$14.14	
Wildlife Area Hosts	Volunteer Hours	Volunteer Miles	Hourly Rate	Estimated Value
			\$17.44	
Education Programs	Volunteer Hours	Volunteer Miles	Hourly Rate	Estimated Value
			\$16.07	
Totals				

