

**ARIZONA GAME AND FISH DEPARTMENT
 HABITAT PARTNERSHIP COMMITTEE
 HABITAT ENHANCEMENT AND WILDLIFE MANAGEMENT PROPOSAL**

Game Branch / HPC Project Number: 15-501

PROJECT INFORMATION

Project Title: Bonita Home Place Water Project

Region and Game Management Unit: Region 5, GMU 31

Local Habitat Partnership Committee (LHPC): • Safford	Was the project presented to the LHPC? YES[x] NO[]
---	--

Has this project been submitted in previous years? YES[] NO[x]
If Yes, was it funded? YES[] NO[] → **Funded HPC Project #(s):**

Project Type: Water Development

Brief Project Summary: Develop two yearlong waters on private property in Bonita Home Place pasture, on the KJ Ranch owned by [REDACTED] and [REDACTED]. Currently, a cased well is located within the pasture. The well will be equipped with a solar powered submersible pump, which will supply water to a 5,000 gallon poly storage tank. Water from the storage tank will be gravity fed via underground water lines to two galvanized stock tanks which will be constructed at a maximum height of 24" to accommodate wildlife, and escape ramps will be installed in each trough.

Big Game Wildlife Species to Benefit: Pronghorn Antelope: 25% Mule Deer: 75%

<p>Implementation Schedule (Month/Day/Year):</p> <p><u>Project Start Date:</u> February 15, 2016</p> <p><u>Project End Date:</u> February 15, 2017</p>	<p>Environmental Compliance: NEPA Completed: Yes[] No[] N/A[X] Projected Completion Date: _____</p> <p>State Historic Preservation Office - Archaeological Clearance: Yes[] No[X] N/A[] Projected Completion Date: Anticipated to be completed by Dec. 15, 2015 by Desert Archaeology in Tucson, AZ.</p> <p>Arizona Game and Fish Department EA Checklist: N/A[] To be Completed by: Rana Tucker - AZGFD, Regional Landowner Incentive Specialist - Partner Biologist Projected Completion Date: January 2016</p>
---	--

PROJECT FUNDING

Special Big Game License Tag Funds Requested:	\$ 15,662
AZGF LRP Funds:	AAF: \$5,300.00 MDF: \$10,362.00
Cost Share or Matching Funds:	\$8,000.00
Total Project Costs:	\$ 5,000.00
	\$ 28,662.00

PARTICIPANT INFORMATION

Applicant (please print): [REDACTED]	Address: [REDACTED]	E-mail: [REDACTED]
--	-------------------------------	------------------------------

[REDACTED]	[REDACTED]	
Telephone: [REDACTED]		Date: August 16, 2015
AGFD Contact and Phone No. (If applicant is not AGFD personnel): Devin Skinner, Wildlife Manager GMU 31 928-651-7582		
Project has been coordinated with: John Bacorn – AZGFD, Wildlife Manager GMU 32 Rana Tucker – AZGFD, Regional Landowner Incentive Specialist - Partner Biologist [REDACTED] [REDACTED] [REDACTED] [REDACTED]		

NEED STATEMENT – PROBLEM ANALYSIS:

Approximately 400 acres of the Bonita Home Place Pasture was grubbed of mesquite in 2014. The area is made up of a native grass lowland with Grant Creek running through the pasture. Mule deer utilize the creek bottom and associated uplands as they cross Fort Grant Road. In 2015, the KJ Ranch modified the bottom strand (smooth wire set at 16” above ground) along 1 ½ miles of the Fort Grant Road right-of-way fence due to issues with mule deer becoming trapped within the right-of-way. The wildlife friendly fence now allows for unencumbered movement by mule deer and pronghorn. Currently, there is no perennial water within the Bonita Home Place pasture. Grant Creek only flows seasonally during heavy rains and does not hold perennial water. By providing yearlong waters, available mule deer and pronghorn habitat will be increased by over 1200 acres. In 2011, the Bonita Grassland Restoration project was started. Over that time, over 2,700 acres of mesquite has been removed, restoring grasslands to the area. Over the next 2 years, an additional 2400 acres will be grubbed. The KJ Ranch is also looking for funding that will result in grubbing to an additional 1,200 acres along the eastern half of the Bonita Home Place and adjoining pastures. As can be seen on the attached map, over the course of the next 3 years, around 7,000 connected acres will be restored to grassland, which will greatly enhance wildlife habitat and improve livestock management throughout the Bonita area.

PROJECT OBJECTIVES:

Develop two yearlong waters within the Bonita Home Place pasture, increasing habitat availability for pronghorn and mule deer in 1200 acres of prime habitat. Both waters will be readily accessible to wildlife and escape ramps will be installed. The development of these waters, along with Fort Grant Road fence modification and the completion of mesquite removal on over 5,400 acres of contiguous land to the west of Bonita will expand the connectivity and permeability of habitats for pronghorn and mule deer.

PROJECT DESCRIPTION AND STRATEGIES:

(How will you implement project)

Upon funding approval, the KJ Ranch will have Tanner Well Service install a solar pump system in an existing cased well. Once completed, water will be pumped to a 5,000 gallon low profile poly storage tank. The tank will be set on a 12 ft x 12 concrete slab with tie downs included. The storage tank will gravity feed water to two - 8ft. x 2 ft. high galvanized stock tanks, which will be

set onto reinforced round slabs to prevent erosion around the sides of the troughs, which would increase trough height and make access into the waters by wildlife more difficult. Water from the storage tank to troughs will be provided by trenching, laying and plumbing 1 ¼ “ SCH 40 PVC water line.

PROJECT LOCATION

(Please provide lat/long in decimal degrees of project area using datum WGS84. If project is larger than one point, please provide multiple lat/long points or an existing shapefile of the project area)



Game Management Unit 31
Graham County

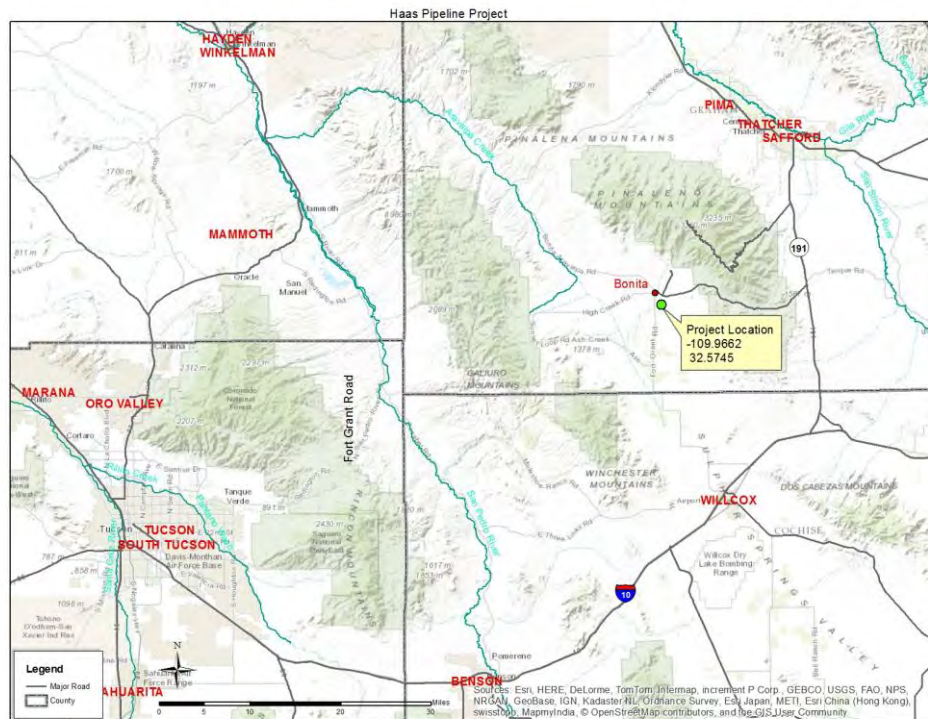

LAND OWNERSHIP AT THE PROJECT SITE(S):

(If the project area is private property, please state specifically and provide the landowner's name)

- [REDACTED]

IF PRIVATE PROPERTY, IS THERE A COOPERATIVE BIG GAME STEWARDSHIP or LANDOWNER AGREEMENT BETWEEN THE LANDOWNER AND THE DEPARTMENT?
YES[X] NO[] N/A[]

[REDACTED] have participated with AZGFD in HPC funded projects in the past and are a vendor with the State of Arizona. A Big Game Stewardship Agreement will be completed for this project, if funded. Additionally, they have entered into agreements with NRCS and the USFWS Partners Program.

HABITAT DESCRIPTION:

According to the NRCS Soil map website, the two dominant ecological sites are Sandy Loam and Clay Upland. The Bonita Home Place Pasture encompasses a lower sandy loam area composed of semidesert grasses and a riparian corridor along Grant Creek. The uplands are composed of clay soils and an abundance of native grasses and forbs. The eastern most portion of the pasture is also made up of medium to high densities of mesquite, which is planned for grubbing as funds become available.

ITEMIZED USE OF FUNDS:

Special Big Game License Tag Funds

Materials Description:

Unit Price

Grundfos 6SQF-3 Solar Pump System, CU 200 Pump Interface
Box & Well Seal. 505' of 1 1/4" SCH 80PVC Drop Pipe & 12/4
Jacketed Sub Wire, 4 – 265 Watt Solar Modules, 6" Pole & Module
Rack, Labor & Required Accessories Included \$8,745.00

5000 Gallon low profile Poly Storage Tank \$5,655.00

2 – 8FT. X.2 FT. Galvanized stock tanks, escape ramp, float valves
& tie down straps included. (\$631.00 each) 1,262.00

Total: SBG License Tag Funds: \$15,662.00

AZGFD Landowner Relations Project (LRP) Funds:

12X12 ft. concrete slab for 5000 gallon tank with tie down loops included. \$5,000.00
Pour two steel reinforced round slabs for stock tanks.

Trenching and installation of 1 1/4 " SCH 40 PVC water line to connect pump, \$3,000.00
Storage tank & stock tanks @ \$2.25/ ft. 500 ' of conduit & control wire installed
To storage tank and control pump @ 0.90/ft.

Total: LRP funds: \$8,000.00

Cost Share or Matching Funds (for volunteer labor rates please refer to the worksheet below)

Archaeological Clearance for storage tank, water line and troughs – KJ Ranch \$5,000.00

Total: Cost Share: \$5,000.00

TOTAL PROJECT COST: \$28,662.00

LIST COOPERATORS AND DESCRIBE POTENTIAL PARTICIPATION:

Tanner Well Service, LLC:

Provide Solar Pump System, required accessories and labor

Provide 5,000 gallon low profile poly storage tank, pour and set concrete slab w/ tie downs

Provide 2 galvanized stock tanks, escape ramps, float valves, tie downs and pour reinforced
slabs.

Trench, install, plumb and bury 1 1/4" SCH 40 PVC water line from well to storage tank to two
troughs.

██████████:

Fund Archaeological Clearance for project.

**WOULD IMPLEMENTATION OF THIS PROJECT ASSIST IN PROVIDING, MAINTAINING,
OR FACILITATING RECREATIONAL ACCESS?**

YES[X] NO[] N/A[]

Even though, the KJ Ranch is not signed up in the Big Game Stewardship Agreement or Landowner

Agreement, [REDACTED] do allow limited hunting on their ranch to those that ask permission and who they feel comfortable with. They do not open their lands to open access and do not wish to enter into an agreement. Yet, the grassland restoration, fence modification and water developments they have completed over the years have, and will continue, to enhance habitat for Pronghorn and Mule Deer. These improvements are critical to enhancing declining wildlife populations throughout the area.

PROJECT MONITORING PLAN:

The Bonita Home Place water will be monitored by the KJ Ranch, and troughs will remain full on a yearlong basis as is the policy of the Ranch.

PROJECT MAINTENANCE:

Maintenance will be performed when needed by the KJ Ranch.

PROJECT COMPLETION REPORT TO BE FILED BY:

[REDACTED]
Arizona Antelope Foundation
Field and Project Manager

WATER DEVELOPMENT PROJECTS (please use the worksheet below):

TREE CLEARING/REMOVAL PROJECTS (please use the worksheet below):

ATTACHMENTS:

(Please provide cultural clearance documentation from land management agency, e.g., FONSI, Inventory Standards, etc. Also attach any project pictures)

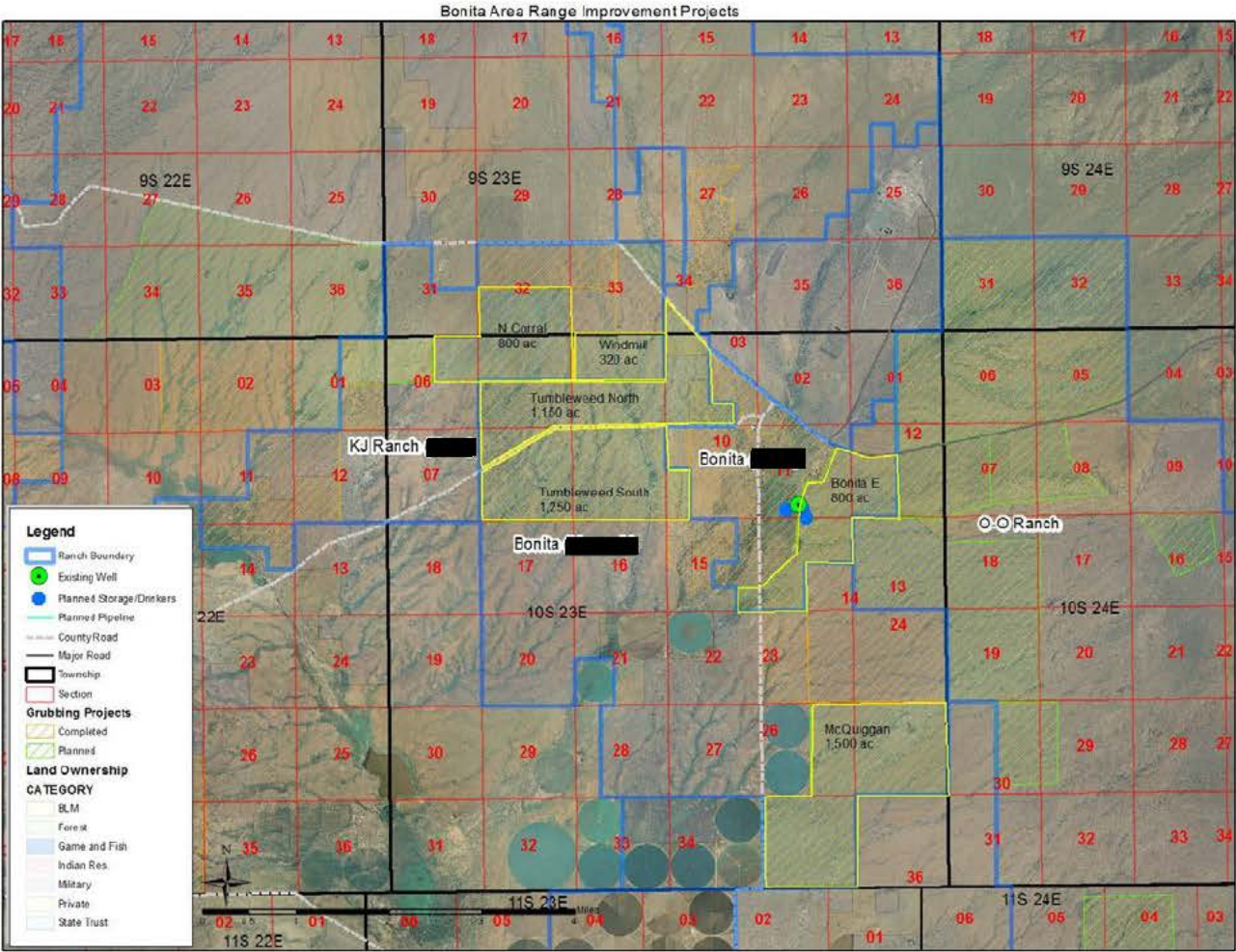

Project map identifying completed and planned grubbing projects.

ARIZONA GAME AND FISH DEPARTMENT WATER DEVELOPMENT WORKSHEET

PROJECT TITLE: _____

- 1) **Is the water development listed as a priority in the most recent “Wildlife Water Development Annual Implementation Schedule?”**
- 2) **Please list the Development Branch personnel and date coordinated with for this project.**
- 3) **What is the estimated annual inches of precipitation for the area? (mark one)**
2-4 4-6 6-8 8-10 10-12 12-14 14-16 >16
- 4) **Is there a perennial water source available to big game within four miles of this project?**

YES (please complete #5 below) NO (skip #5 below)

- 5) **For the accessible, perennial water source nearest this project:**

Name of water source:

Type of water source (catchment, spring, dirt tank):

Ownership of water source:

Distance in miles from project:

- 6) **Is the target wildlife species a result of transplant efforts? YES NO**

- 7) **Please list any special land management status for the project site (i.e. Wilderness, National Park, National Monument). If private land, list landowner.**

- 8) **Please provide the following information about access to the proposed site:**

Type of access (mark one): 2x4 vehicles 4x4 only foot only**

**If foot access only: Distance in miles: _____ Approximate hiking time: _____

-- Does access to this site require crossing private or tribal lands? YES NO

-- Please describe any restrictions to public access:

- 9) **Please list below (or on a separate sheet) the material type and dimensions of each component proposed to be added, modified, or repaired.**

- 10) **Was a site visit completed? Yes No**

If Yes, please list personnel that attended and date.