

**ARIZONA GAME AND FISH DEPARTMENT  
HABITAT PARTNERSHIP PROGRAM  
HABITAT ENHANCEMENT AND WILDLIFE MANAGEMENT PROPOSAL**

<b>PROJECT INFORMATION</b>	
<b>Project Title:</b> Silverbell Pipeline Project	<b>Project No. 09-515</b>
<b>Region/GMU:</b> 5/37A	<b>HPC:</b> Tucson
<b>Project Type:</b> Cooperative Water Development Project with Rancher	
<p><b>Project Description:</b>            This project will provide perennial water to within 1.5 miles of <b>34 sections</b> of land by installing 5 miles of 200 psi NuMex pipeline from the CAP canal south and connecting it to an existing 8 mile pipeline. Along the 5 mile segment being proposed, we will install 3 wildlife friendly livestock drinkers and one 6,000 gallon storage tank. The drinkers will have ramps constructed with rocks and mortared together on both the inside and outside of the troughs so that all wildlife including juvenile javelina will have access to water. The existing 8-mile segment, which contains 8 drinkers and 30,000 gallons of storage (3-6,000 gallon tanks and 1-12,000-gallon tank), currently does not have a reliable water source. Our intent is to provide a permanent reliable water source (CAP canal) to this segment while adding additional watering sites in between.</p>	
<b>Wildlife Species to Benefit:</b> mule deer, bighorn sheep, javelina	
<b>Possible Funding Partners:</b>	
<b>Implementation Schedule:</b> <b>Beginning:</b> September 1, 2009 <b>Completed:</b> December 31, 2010	<b>NEPA Compliance: (if applicable)</b> <b>Completed:</b> Yes <input checked="" type="checkbox"/> No <input type="checkbox"/> <b>Projected Completion Date:</b> N/A
<b>PROJECT FUNDING</b>	
<b>SBG Funds Requested:</b> \$16,000	
<b>Cost Share Funds:</b> Existing 8 miles- \$123,235 + new 5 miles - \$46,050 = \$169,285	
<b>Total Project Costs:</b> \$185,285	
<b>PARTICIPANT INFORMATION</b>	
<b>Applicant:</b> Matthew Kile  <b>Telephone:</b> 520-251-3006 520-251-1728	<b>Address:</b> P.O. Box 111 Picacho, AZ 85241
<b>AGFD Contact and Phone No.</b>	
<b>(If applicant is not AGFD personnel)</b> Bob Lemons (520) 877-4360	
<b>Coordinated with:</b> Ed Kile (Mammoth Wash Ranch), Alicia Phipps (NRCS), John Patton (state land dept.)	<b>Date:</b> 8/20/09
<b>Applicant's signature:</b>	<b>Date:</b> September 1, 2009

**SEND COMPLETED APPLICATIONS TO:**  
**Game Branch**  
**2221 W. Greenway Rd.**

Phoenix, AZ 85023  
rothompson@azgfd.gov

WAS PROJECT PRESENTED TO THE LOCAL HPC? YES  NO

HAS PROJECT BEEN SUBMITTED IN PREVIOUS YEARS? IF SO WAS IT FUNDED?

No

**NEED STATEMENT/PROBLEM ANALYSIS:**

Mammoth Wash Ranch is located within the Silverbell mountain range. Prior to us assuming control of the ranch, all watering facilities were inoperable leaving no water available for wildlife or livestock. Since we have acquired the lease, we have drilled three wells, refurbished two others, and installed 8 miles of pipeline which has helped, however, there is still a lot of country dry. Since we have had the ranch, we have observed several deer which have drowned in the CAP canal four miles north of the ranch. After much research, we have concluded that installing a pipeline from the CAP canal to the ranch is feasible and would help to alleviate many issues. By installing a drinker near the CAP canal, we feel it would benefit wildlife and prevent needless drownings. We are currently working with the State Land Department and the NRCS, which have been very helpful in plotting courses for the pipeline, along with mapping and engineering. We feel that this project would greatly enhance this area for both livestock and wildlife. The drinkers will have ramps constructed with rocks and mortared together on both the inside and outside of the troughs so that all wildlife including juvenile javelina will have access to water.

**PROJECT OBJECTIVES:**

- To increase deer and javelina populations by providing dependable, long term, self-sustaining, quality water sources on a landscape scale and by increasing the use of otherwise unavailable forage resources
- To improve forage conditions in four different allotments by spacing waters no more than 1.5 miles apart. Livestock will be less likely to over browse areas close to water and more likely to utilize the allotments equally.
- To increase hunter opportunity
- To improve relations with the ranching community

**PROJECT STRATEGIES:**

Provide perennial water to within 1.5 miles of **34 sections** of land by installing 5 miles of 200 psi NuMex pipeline from the CAP canal south and connecting it to an existing 8 mile pipeline. Along the 5-mile segment being proposed, we will install three wildlife friendly livestock drinkers and one 6,000-gallon storage tank. The drinkers will have ramps constructed with rocks and mortared together on both the inside and outside of the troughs so that all wildlife including juvenile javelina will have access to water. The existing 8-mile segment, which contains 8 drinkers and 30,000 gallons of storage (3-6,000 gallon tanks and 1- 12,000-gallon tank), currently does not have a reliable water source. Our intent is to provide a permanent reliable water source (CAP canal) to this segment while adding additional watering sites in between. The rancher will operate and maintain the water supply, pipe and drinkers.

- Mammoth Wash Ranch (Kile Family) – Install and maintain all aspects of the project.
- AGFG – Cost-share the pipeline for the project
- NRCS – Mapping and engineering requirements for the project.
- ASLD – Process all environmental compliance documents for the project.

**PROJECT LOCATION:**

The project is located northwest of Tucson and south of Casa Grande in Game Management Unit 37A.  
Starting at Aries Rd. and Overfield Rd.

- See maps on next two pages for specific locations

TOPO! map printed on 08/26/09 from "Untitled.tpo"

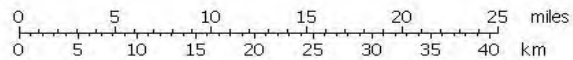
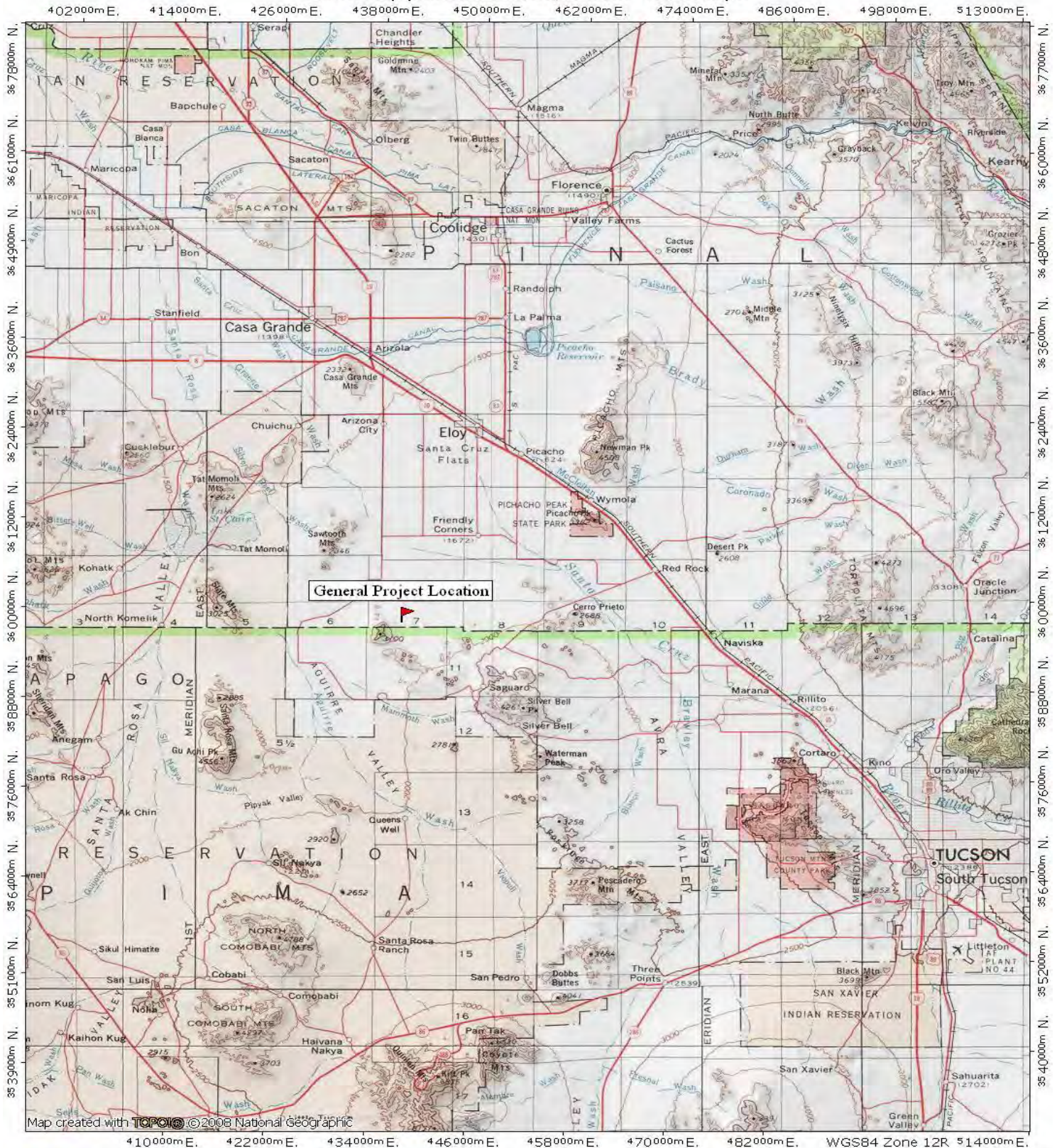

TN MN  
11°  
08/26/09

Approximate Pipeline Length: 29,000'

### Big Horn Pipeline

Date: 8/24/2009  
Legal Description: Sections 16, 21, 28, 33, T10S, R7E &  
Sections 2 & 3, T11S, R7E

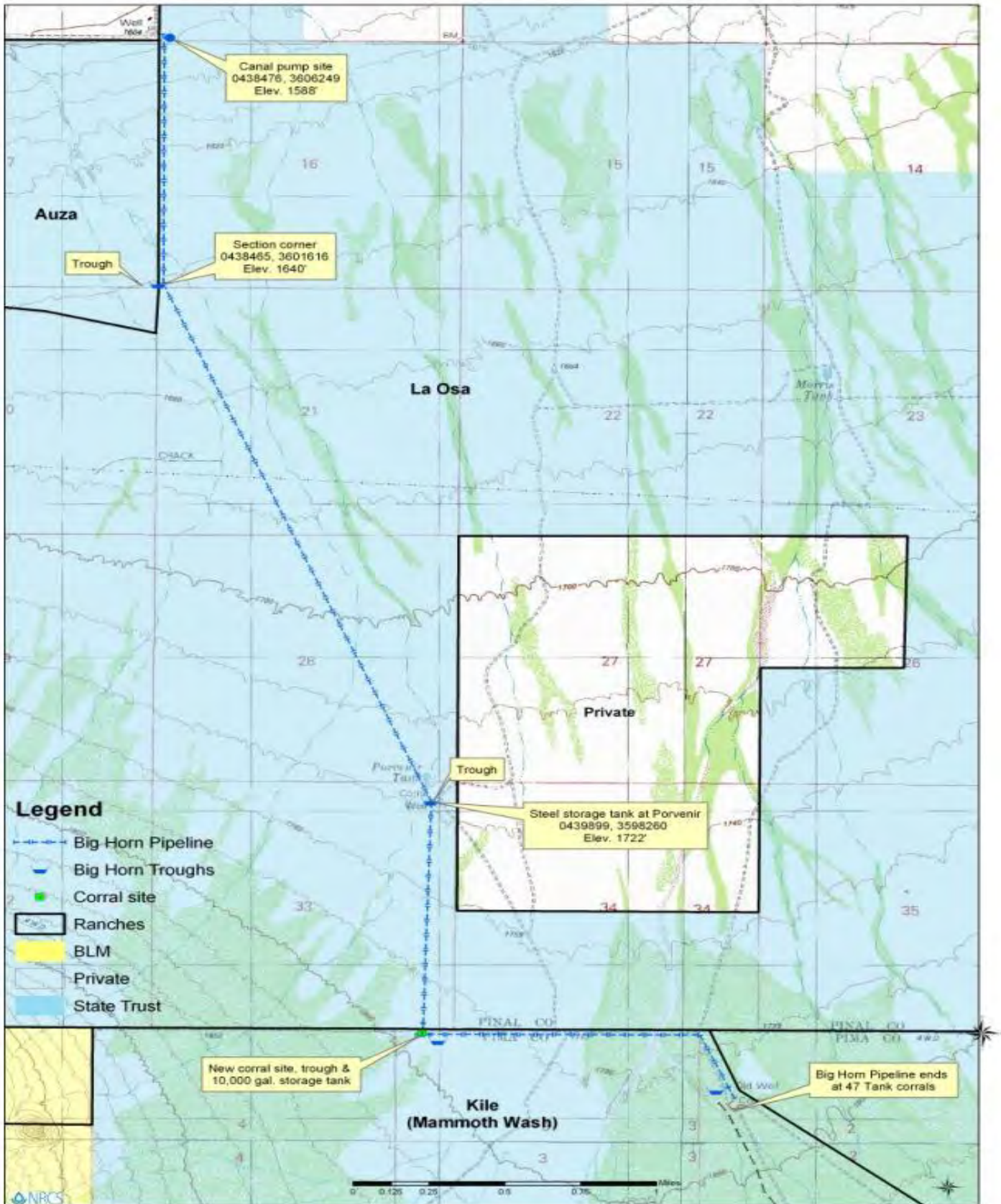

**LAND OWNERSHIP AT PROJECT SITE (Please state specifically if PRIVATE PROPERTY and provide landowner's name):**

The project site is on land administered by the Arizona State Land Department, Tucson Field Office, 4455 S. Park Avenue Suite 101 Tucson, Arizona 85714 (520) 628-5480.

**IF PRIVATE PROPERTY, IS THERE A STEWARDSHIP AGREEMENT BETWEEN THE LANDOWNER AND THE DEPARTMENT?**

N/A

**HABITAT DESCRIPTION:**

Game management unit 37A is located in Pima and Pinal Counties, Arizona, west of Tucson and south of Phoenix. Two main biotic community types, Sonoran Desertscrub and Semidesert Grassland, comprise the bulk of the habitat in 37A. The proposed project is located in the Sonoran Desertscrub community. Common vegetation includes foothill palo verde (*Cercidium microphyllum*), mesquite (*Prosopis spp.*), saguaro (*Carnegiea gigantea*), ocotillo (*Fouquieria splendens*), and triangle-leaf bursage (*Ambrosia deltoidea*). Average rainfall is approximately 10-13" and elevation is approximately 1700'.

**ITEMIZED USE OF FUNDS:**

Item	Quantity	Est. Cost/Item	Total Est. Cost	Total Kile Family Cost Share	AGFD
200 psi pipe	29000'	\$1.73/foot installed	\$50,170	\$46,050	\$16,000
Troughs	3000 gal	\$1.32/gallon	\$3,960		
Storage Tanks	6000	\$1.32/gallon	\$7,920		
<b>Total</b>			<b>\$62,050</b>	<b>\$46,050</b>	<b>\$16,000</b>

**Note: The estimated costs/item are current NRCS estimates**

**Note: Below is an estimated value of the existing 8 mile segment of pipeline using current NRCS cost figures.**

Item	Quantity	Est. Cost/Item	Total Est. Cost
200 psi pipe	42,240	\$1.73/foot installed	\$73,075
Troughs	8000	\$1.32/gallon	\$10,560
Storage Tanks	30000	\$1.32/gallon	\$39,600
<b>Total</b>			<b>\$123,235</b>

**Total Cost Share = Existing (\$123,235) + New (\$46,050) =\$169,285**

**LIST COOPERATORS AND DESCRIBE POTENTIAL PARTICIPATION:**

- Mammoth Wash Ranch (Kile Family) – Install and maintain all aspects of the project.
- AGFG – Cost-share the pipeline for the project
- NRCS – Mapping and engineering requirements for the project.
- ASLD – Process all environmental compliance documents for the project.

**PROJECT MONITORING PLAN:**

The Kile family will monitor this pipeline and associated drinkers.

**PROJECT MAINTENANCE:**

The maintenance of this project will be the responsibility of the Kile family.

**PROJECT COMPLETION REPORT TO BE FILED BY:**

Bob Lemons

**WATER DEVELOPMENT PROJECTS (see attached worksheet):**

**TREE SHEARING (AGRA-AXE, PUSH) PROJECTS (see attached worksheet):**

**ARIZONA GAME AND FISH DEPARTMENT**  
**WATER DEVELOPMENT WORKSHEET**

**PROJECT NAME:** Silverbell Pipeline Project

- 1) **Is the water development listed as a priority in the most recent “Wildlife Water Development Annual Implementation Schedule?”**  
Yes
- 2) **Please list the Development Branch personnel and date coordinated with for this project.**  
N/A
- 3) **What is the estimated annual inches of precipitation for the area? (mark one)**  
   2-4    4-6    6-8   X 8-10    10-12    12-14    14-16    >16
- 4) **Is there a perennial water source available to big game within four miles of this project?**  
   YES (please complete #5 below)   X NO (skip #5 below)
- 5) **For the accessible, perennial water source nearest this project:**  
Name of water source:  
Type of water source (catchment, spring, dirt tank, etc.):  
Ownership of water source:  
Distance in miles from project:
- 6) **Is the target wildlife species a result of transplant efforts?**    YES   X NO
- 7) **Please list any special land management status for the project site (i.e. Wilderness, National Park, National Monument, etc). If private land, list landowner.**  
N/A
- 8) **Please provide the following information about access to the proposed site:**  
Type of access (mark one):   X 2x4 vehicles    4x4 only    foot only\*\*  
\*\*If foot access only: Distance in miles:   Approx. hiking time:  
  
-- Does access to this site require crossing private or tribal lands?    YES   X NO  
  
-- Please describe any restrictions to public access:
- 9) **Please list below (or on a separate sheet) the material type and dimensions of each component proposed to be added, modified, or repaired.**



Item	Quantity	Est. Cost/Item	Total Est. Cost	Total Kile Family Cost Share	AGFD
200 psi pipe	29000'	\$1.73/foot installed	\$50,170	\$46,050	\$16,000
Troughs	3000 gal	\$1.32/gallon	\$3,960		
Storage Tanks	6000	\$1.32/gallon	\$7,920		
<b>Total</b>			<b>\$62,050</b>	<b>\$46,050</b>	<b>\$16,000</b>

**Note: The estimated costs/item are current NRCS estimates**

**Note: Below is an estimated value of the existing 8 mile segment of pipeline using current NRCS cost figures.**

Item	Quantity	Est. Cost/Item	Total Est. Cost
200 psi pipe	42,240	\$1.73/foot installed	\$73,075
Troughs	8000	\$1.32/gallon	\$10,560
Storage Tanks	30000	\$1.32/gallon	\$39,600
<b>Total</b>			<b>\$123,235</b>

**Total Cost Share = Existing (\$123,235) + New (\$46,050) = \$169,285**

**10) Was a site visit completed?  Yes  No**

A site visit was completed with Wildlife Manager Bob Lemons in May 2008