

NEPA COMPLIANCE RECORD

Categorical Exclusion (CX)



Bureau of Land Management
Safford Field Office
Safford, AZ

I. PROJECT INFORMATION

NEPA #: DOI-BLM-AZ-G010-2016-0026-CX	Serial/Case File No.:														
Title: Cerro Hueco Allotment (06140) Grazing Preference Transfer															
Proposed Action/Type: Transfer of Preference															
Proposed Action (Who, What, When, Where, How): A section 15 grazing lease transfer of preference from Nicolls Brothers to Don C. Nicoll, Steven D. Nicoll, and Cody N. Weagant with Don C. Nicoll as the authorized representative. The allotment is located 17 miles Southwest of St Johns, AZ in Apache County.															
Authorization Schedule Information:															
<table border="1"><thead><tr><th>Allot #</th><th>Allot Name</th><th>Livestock</th><th>Livestock Kind</th><th>Begin</th><th>End</th><th>AUMS</th></tr></thead><tbody><tr><td>06140</td><td>CERRO HUECO</td><td>58</td><td>CATTLE</td><td>3/1/2016</td><td>2/28/2017</td><td>696</td></tr></tbody></table>		Allot #	Allot Name	Livestock	Livestock Kind	Begin	End	AUMS	06140	CERRO HUECO	58	CATTLE	3/1/2016	2/28/2017	696
Allot #	Allot Name	Livestock	Livestock Kind	Begin	End	AUMS									
06140	CERRO HUECO	58	CATTLE	3/1/2016	2/28/2017	696									
Allotment is located on all sections: T 11N R 25E Sec. 36, T 11N R 26E Sec. 12, 13, 19, 20, 21, 22, 23, 24, 25, 26, 27, 28, 30 of which Sec. 12, 20, 22, 24, and 25 are BLM-managed lands (see map included).															
The transfer of grazing preference for the Cerro Hueco Allotment is to new permittees in the same family as it has been in the past. No changes are being made or being proposed on the allotment other than this change of name.															
<input checked="" type="checkbox"/> Map Attached See Attachment 1															
Applicant (if any): Don C. Nicoll															
Applicable CX: 516 DM 11, 11.9, D (1): Approval of transfers of grazing preference.															

II. PLAN CONFORMANCE REVIEW

This proposed action is subject to the following land use plan:

Safford District Resource Management Plan (RMP), Final Environmental Impact Statement (August 1991), and partial Records of Decision approved September 1992 and July 1994.

The proposed action has been reviewed and determined to be in conformance with this plan [43 CFR 1610.5, BLM MS 1601.04(C)(2)].

Project Lead

5-11-16
Date



III. RESOURCE PROGRAM CONSULTATION & COORDINATION

III (A). CX Applicability/ Exception Review

Date Internal Scoping Initiated: 5-23-16 Date Internal Scoping Closed: 5-24-16				
Applies? Yes No	NAME	EXTRAORDINARY CIRCUMSTANCE (EXCEPTION)	SIGNATURE*	DATE
<i>*Signature indicates that I have reviewed the project to determine the applicability of an extraordinary circumstance.</i>				
If any of the following extraordinary circumstances are applicable to the action being considered, either an EA or EIS must be prepared for the action. Brackets [#] refers to corresponding BLM NEPA Handbook H-1790-1 Appendix 5 Categorical Exclusions: Extraordinary Circumstances (per 516 DM 2, Appendix 2.)				
<input type="checkbox"/> <input checked="" type="checkbox"/>	RJ Estes	(1) Have significant impacts on public health or safety. [2.1]	RJ Estes	5/23/16
<input type="checkbox"/> <input checked="" type="checkbox"/>	Amelia Underwood Taylor	(2) Have significant effects on such unique geographic characteristics as prime farmlands; sole or principal drinking water aquifers; wetlands (Executive Order 11990); or floodplains (Executive Order 11988). [2.2]	AJT	5/23/16
<input type="checkbox"/> <input checked="" type="checkbox"/>	Todd Murdock	(3) Have significant effects on such natural resources and unique geographic characteristics as park, recreation or refuge lands; national natural landmarks; national monuments; wilderness areas; wild or scenic rivers; or ecologically significant or critical areas. [2.2]	Todd Murdock	5/23/16
<input type="checkbox"/> <input checked="" type="checkbox"/>	Dan McGrew	(4) Have significant impacts on properties listed, or eligible for listing, on the National Register of Historic Places [2.7], or on such unique geographic characteristics as historic or cultural resources. [2.2] Violate a Federal law, or a State, local, or tribal law or requirement imposed for the protection of the environment. [2.9] Limit access to and ceremonial use of Indian sacred sites on Federal lands by Indian religious practitioners or significantly adversely affect the physical integrity of such sacred sites (Executive Order 13007). [2.11]	Dan McGrew	5/23/2016
<input type="checkbox"/> <input checked="" type="checkbox"/>	Jeff Conn/ Mark McCabe	(5) Have significant impacts on species listed, or proposed to be listed, on the List of Endangered or Threatened Species, or have significant effects on designated Critical Habitat for these species. [2.8] Have significant impacts on migratory birds. [2.2]	McCabe	5/24/2016
<input type="checkbox"/> <input checked="" type="checkbox"/>	Jason Martin	(6) Contribute to the introduction, continued existence, or spread of noxious weeds or non-native invasive species known to occur in the area or actions that may promote the introduction, growth, or expansion of the range of such species (Federal Noxious Weed Control Act and Executive Order 13112). [2.12]	Jason Martin	5/23/16
<input type="checkbox"/> <input checked="" type="checkbox"/>	[AFM]	(7) Have highly controversial environmental effects or involve unresolved conflicts concerning alternative uses of available resources [42 USC 4332(2)(E)]. [2.3]	AJT	5/23/16
<input type="checkbox"/> <input checked="" type="checkbox"/>	[Project Lead]	(8) Have highly uncertain and potentially significant environmental effects or involve unique or unknown environmental risks. [2.4]	Project Lead	5/23/16
<input type="checkbox"/> <input checked="" type="checkbox"/>	[AFM]	(9) Establish a precedent for future action or represent a decision in principle about future actions with potentially significant environmental effects. [2.5]	AJT	5/23/16
<input type="checkbox"/> <input checked="" type="checkbox"/>	[Project Lead]	(10) Have a direct relationship to other actions with individually insignificant but cumulatively significant environmental effects. [2.6]	Project Lead	5/23/16
<input type="checkbox"/> <input checked="" type="checkbox"/>	Sharisse Fisher	(11) Have a disproportionately high and adverse effect on low income or minority populations (Executive Order 12898). [2.10]	Sharisse Fisher	5/23/16

III (B). Critical Resources Review



Critical Resource	Specialist	Affected, but less than Significant		Comments		Signature	Date
		Yes	No	Yes	No		
1. NRHP/Cultural	D. McGrew		✓		✓	<i>D. McGrew</i>	5/23/16
2. TES Species	J. Conn/ M. McCabe		✓		✓	<i>M. McCabe</i>	5-24-16
3. Floodplains/Wetlands	A. Underwood Taylor.		✓		✓	<i>A. Underwood</i>	5/23/16
4. Invasive Species	J. Martin		✓		✓	<i>J. Martin</i>	5/23/16

Comments/Attachments: _____

IV. FINAL REVIEW

This proposed action qualifies as a categorical exclusion under the National Environmental Policy Act in accordance with BLM

516 DM 11, 11.9, D (1): Approval of transfers of grazing preference.

This categorical exclusion is appropriate in this situation because there are no extraordinary circumstances potentially having effects that may significantly affect the environment. It has been reviewed to determine if any of the exceptions described in BLM 516 DM 2, Appendix 2, apply.

The action does not have significant adverse effects on public health and safety nor does the action adversely affect such unique geographic characteristics as historic or cultural resources, parks, recreation, or refuge lands, wilderness areas, wild or scenic rivers, sole or principal drinking water aquifers, prime farmlands, wetlands, floodplains, or ecologically significant or critical areas, including those listed on the Department's National Register of Natural Landmarks. The action does not have highly controversial environmental effects nor have highly uncertain environmental effects or involve unique or unknown environmental risk nor does it adversely affect a species listed or proposed to be listed on the list of endangered or threatened species. It does not establish a precedent for future action or represent a decision in principle about a future consideration with significant environmental effects or related to other actions with individually insignificant but cumulatively significant environmental effects. The proposed action does not adversely affect properties listed or eligible for listing in the National Register of Historic Places or threaten to violate a Federal, State, local or tribal law or requirements imposed for the protection of the environment or which require compliance with Executive Order 11988 (Floodplain Management), Executive Order 11990 (Protection of Wetlands) or the Fish and Wildlife Coordination Act.

Mitigation Measures/Stipulations:



NEPA Coordinator: Amy Corathers Date: 5-25-14

Assistant Field Manager: Ann Tyle Date: 5/27/16
Recommended

V. DECISION

I have reviewed this plan conformance and NEPA compliance record and have determined that the proposed action does not conflict with major land use plans and will not have any significant impacts on environmental resources. Therefore, it does not represent an exception, and is categorically excluded from further environmental review. It is my decision to implement the project, as described, with the incorporation of the mitigation measures specified in Section IV above.

Authorized Official: [Signature] Date: 5/31/16
for Scott C. Cooke
Field Manager

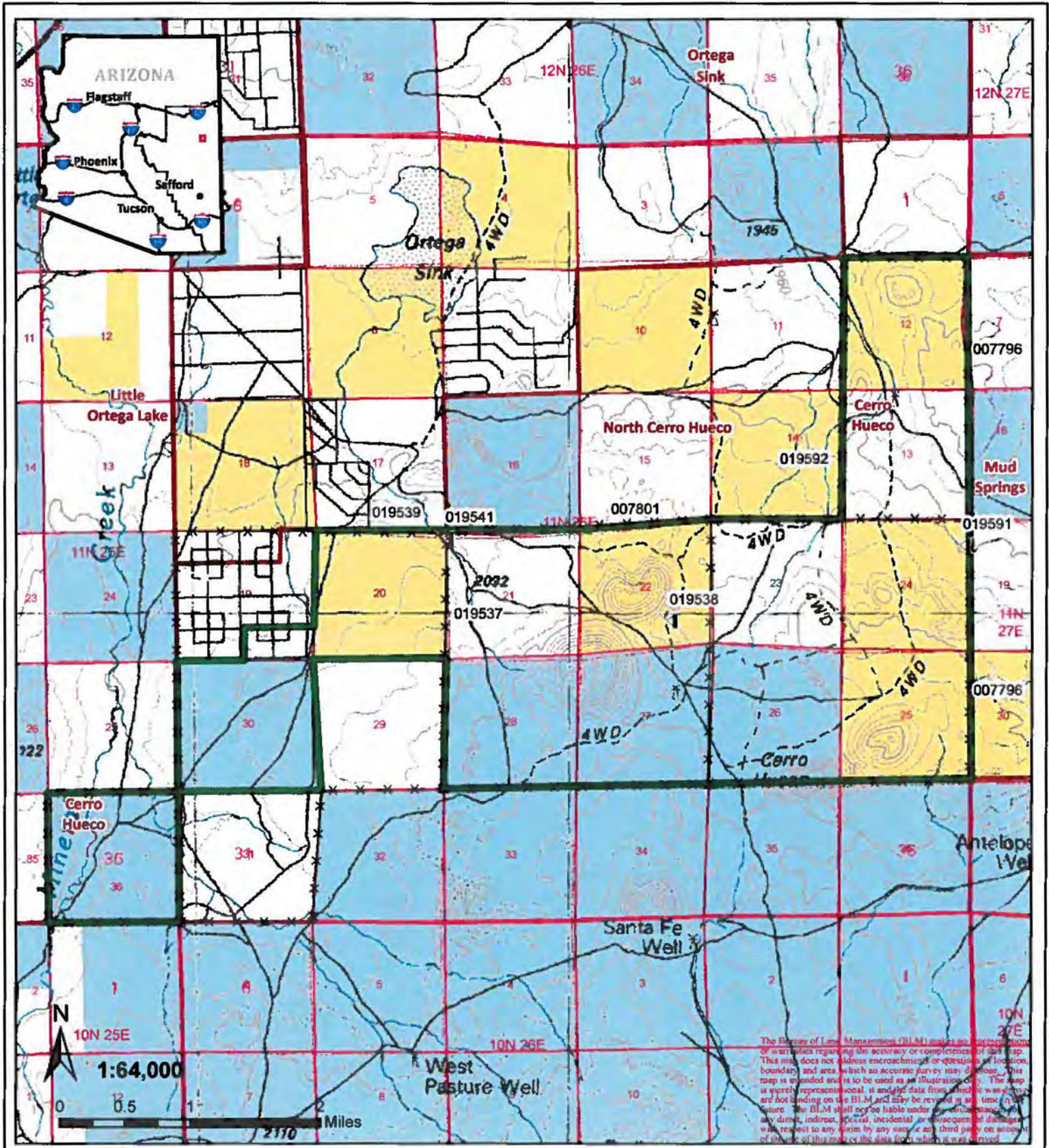

The Bureau of Land Management (BLM) makes no representation or warranty regarding the accuracy or completeness of this map. This map does not address encroachments or questions of location, boundary, and area which an accurate survey may disclose. This map is intended and is to be used as an illustration only. The map is solely representational, is dated data from which it was derived and not binding on the BLM and may be revised at any time in the future. The BLM shall not be liable under any circumstances for any direct, indirect, special, incidental or consequential damages with respect to any claim by any user of any third party on account of reliance on this map or the data from which it was derived.



US Department of the Interior
Bureau of Land Management
Safford Field Office

Cerro Hueco Allotment

- Dirt Tank
- BLM
- Cerro Hueco Allotment
- Private
- SFO Grazing Allotments
- State
- Fence

Date Created: 5/25/2016
Author: rpatterson