

**ARIZONA GAME AND FISH DEPARTMENT  
HABITAT PARTNERSHIP COMMITTEE  
HABITAT ENHANCEMENT AND WILDLIFE MANAGEMENT PROPOSAL**

Game Branch / HPC Project Number: 14-529

**PROJECT INFORMATION**

**Project Title:** Silverbell Pipeline Project Project phase 3

**Region and Game Management Unit:** Region 5, GMU 37A

**Local Habitat Partnership Committee (LHPC):**  
• Tucson

**Was the project presented to the LHPC?**  
YES[] NO[X]

**Has this project been submitted in previous years?** YES[X] NO[]

**If Yes, was it funded?** YES[] NO[X] → **Funded HPC Project #(s):**

**Project Type:** Cooperative Water Development Project with Rancher

**Brief Project Summary:** This is phase three of the Silverbell Pipeline Project. Phase one and two have been funded and completed. Phase three will continue one of the phase two water lines for approximately two miles with the installation of storage tank and water troughs. Phase three will also include the removal of two gas powered well pumps and replaced with solar.

**Big Game Wildlife Species to Benefit:** Mule deer, big horn sheep and javelina

**Implementation Schedule** (Month/Day/Year):

Project Start Date: September 1, 2014

Project End Date: September 1, 2015

**Environmental Compliance:**

NEPA Completed: Yes[] No[] N/A[]

Projected Completion Date: To be completed by Darrell Tersey

State Historic Preservation Office - Archaeological Clearance:

Yes[] No[] N/A[]

Projected Completion Date: \_\_\_\_\_

Arizona Game and Fish Department EA Checklist: N/A[]

To be Completed by: \_\_\_\_\_

Projected Completion Date: \_\_\_\_\_

**PROJECT FUNDING**

**Special Big Game License Tag Funds Requested:** \$ 5000.00

**Cost Share or Matching Funds:** \$ 26,700.00

**Total Project Costs:** \$ 31,700.00

**PARTICIPANT INFORMATION**

**Applicant** (please print):  
Ed Kile

**Address:** [REDACTED]  
[REDACTED]

[REDACTED]

**Telephone:** [REDACTED]

**Date:** 8/30/2013

**AGFD Contact and Phone No.** (If applicant is not AGFD personnel):

Allison Dutt (520)240-1019

**Project has been coordinated with:**

Ed Kile (Mammoth Wash Ranch) Alicia Phipps (NRCS) and Darrell Tercey (BLM)

**NEED STATEMENT – PROBLEM ANALYSIS:**

Mammoth was Ranch is located within the Silverbell mountain range. Prior to us assuming control of the ranch, all watering facilities were inoperable leaving no water available for wildlife or livestock. Since we have acquired the lease, we have drilled three wells, refurbished two others, and installed 8 miles of pipeline which has helped, however, there is still a lot of dry country. Phase one and two has provided perennial water for five new drinking facilities for wildlife. Phase three will add two additional water facilities for wildlife and livestock.

**PROJECT OBJECTIVES:**

To increase mule deer, javelina and big horn sheep populations by continuing to extend water lines and storage facilities.

**PROJECT DESCRIPTION AND STRATEGIES:**

Continue to provide water sources in needed areas

**PROJECT LOCATION:**

The project is located west of Tucson, and northwest of the town of Three Points, in Game Management Unit 37A.

**LAND OWNERSHIP AT THE PROJECT SITE(S):**

(if the project area is private property, please state specifically and provide the landowner's name)

- BLM

*IF PRIVATE PROPERTY, IS THERE A COOPERATIVE BIG GAME STEWARDSHIP or  
LANDOWNER AGREEMENT BETWEEN THE LANDOWNER AND THE DEPARTMENT?*

YES[] NO[] N/A[X]

**HABITAT DESCRIPTION:**

Two main biotic community types, Sonoran Desertscrub and Semidesert Grassland, comprise the bulk of the habitat in 37A. The proposed project is located in the Sonoran Desertscrub community. Common vegetation includes foothills palo verde, mesquite, saguaro, ocotillo and triangle-leaf bursage. Average rainfall is approximately 10-13" and elevation is approximately 1700'.

**ITEMIZED USE OF FUNDS:**

Item	Quantity	Est.cost/item	Total Est. Cost	Kile Family Share	AGFD
200 psi pipe trough Storage Solar Pumps	10560ft 2 2000 gal 2	1.73/foot 396.00 2640.00 5000.00	\$18,268.00 792.00 2640.00 10,000.00	26,700.00	5000.00
			<b>\$31,800.27</b>		

Cost Share or Matching Funds (for volunteer labor rates please refer to the worksheet below)

NRCS

**LIST COOPERATORS AND DESCRIBE POTENTIAL PARTICIPATION:**

Mammoth Wash Ranch (Kile Family) - Install and maintain all aspects of the project.

**WOULD IMPLEMENTATION OF THIS PROJECT ASSIST IN PROVIDING, MAINTAINING, OR FACILITATING RECREATIONAL ACCESS?**

YES[] NO[X] N/A[]

**PROJECT MONITORING PLAN:**

The Kile family will monitor this pipeline, troughs, storage tanks and solar pumps

**PROJECT MAINTENANCE:**

The maintenance of this project will be the responsibility of the Kile family.

**PROJECT COMPLETION REPORT TO BE FILED BY:**

A. Dutt, AGFD Region V GMU 38M/37A Wildlife Manager

**WATER DEVELOPMENT PROJECTS (please use the worksheet below):**

**TREE CLEARING/REMOVAL PROJECTS (please use the worksheet below):**

None

## **ARIZONA GAME AND FISH DEPARTMENT** **WATER DEVELOPMENT WORKSHEET**

**PROJECT TITLE:** Silverbell Pipeline Project Project phase 3

- 1) **Is the water development listed as a priority in the most recent “Wildlife Water Development Annual Implementation Schedule?”**  
Yes
- 2) **Please list the Development Branch personnel and date coordinated with for this project.**  
N/A
- 3) **What is the estimated annual inches of precipitation for the area? (mark one)**  
☐2-4   ☐4-6   ☐6-8   ☒8-10   ☐10-12   ☐12-14   ☐14-16   ☐ >16
- 4) **Is there a perennial water source available to big game within four miles of this project?**  
  
YES☒ (please complete #5 below)   NO☐ (skip #5 below)
- 5) **For the accessible, perennial water source nearest this project:**  
Name of water source: CAP and ranch wells  
Type of water source (catchment, spring, dirt tank):  
Ownership of water source:  
Distance in miles from project:
- 6) **Is the target wildlife species a result of transplant efforts?** YES☐   NO☒
- 7) **Please list any special land management status for the project site (i.e. Wilderness, National Park, National Monument). If private land, list landowner.**  
N/A
- 8) **Please provide the following information about access to the proposed site:**  
Type of access (mark one): ☒2x4 vehicles   ☐4x4 only   ☐foot only\*\*  
  
\*\*If foot access only: Distance in miles: \_\_\_\_\_   Approximate hiking time: \_\_\_\_\_  
  
-- Does access to this site require crossing private or tribal lands? YES☐   NO☒  
  
-- Please describe any restrictions to public access: None
- 9) **Please list below (or on a separate sheet) the material type and dimensions of each component proposed to be added, modified, or repaired.**

Item	Quantity	Est.cost/item	Total Est. Cost	Kile Family Share	AGFD
200 psi pipe	10560ft	1.73/foot	\$18,268.00	26,700.00	5000.00
trough	2	396.00	792.00		
Storage	2000 gal	2640.00	2640.00		
Solar Pumps	2	5000.00	10,000.00		

**10) Was a site visit completed?** Yes[X] No[]

**If Yes, please list personnel that attended and date.**



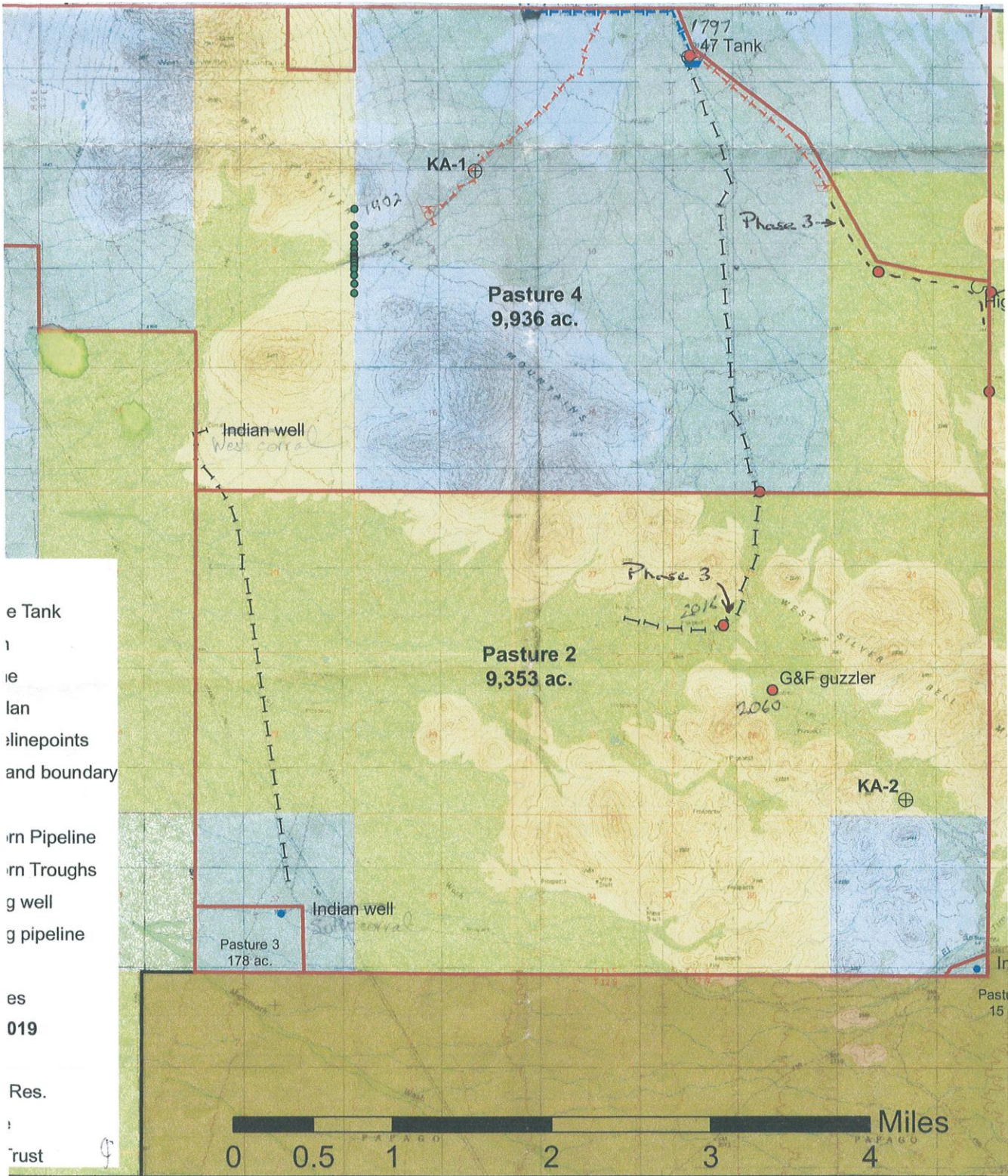

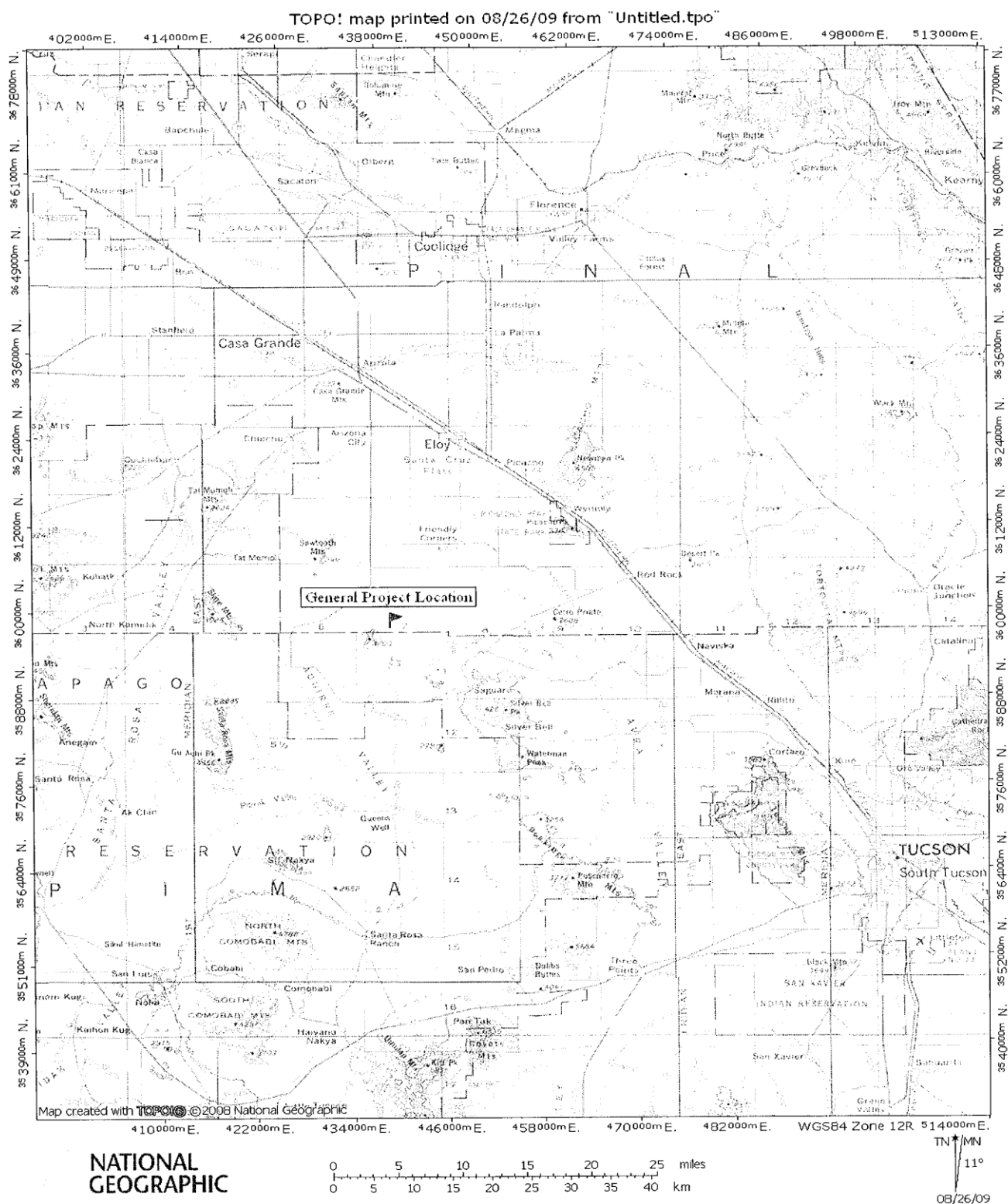

(revised 7-02-2007)